



Champaign County Mental Health Board (CCMHB) Study Session Agenda

Wednesday, January 26, 2022 at 5:45PM

Shields-Carter Room, Brookens Administrative Building, 1776 E. Washington Street, Urbana, IL
<https://us02web.zoom.us/j/81393675682> 312-626-6799, Meeting ID: 813 9367 5682

Pursuant to the Governor's Executive Order establishing a pandemic disaster in the State of Illinois that covers the County of Champaign, and the CCMHB President's determination that holding this meeting in person is not prudent at this time due to health concerns with rising numbers of COVID-19 cases and hospitalizations being reported in the county, this meeting will be held remotely via zoom. Public comment also will be taken remotely. The public may watch the meeting live through this link or view it later in archived recordings at

<https://www.co.champaign.il.us/mhbddb/MeetingInfo.php>

Public Input: All are welcome to attend the Board's meetings, using the Zoom options or in person, in order to observe and to offer thoughts during the "Public Participation" period of the meeting. For support to participate during a meeting, let us know how we might help by emailing stephanie@ccmhb.org. If the time or format of the meeting are not convenient, you may still communicate with the Board by emailing stephanie@ccmhb.org any written comments you would like us to read to the Board during the meeting. Your feedback is appreciated but be aware that the time for each person's comments may be limited to 5 minutes.

1. Call to Order
2. Roll Call
3. Zoom Instructions (**page 2**)
4. Approval of Agenda*
5. Citizen Input/Public Participation
The CCMHB reserves the authority to limit individual public participation to 5 minutes and limit total time to 20 minutes.
6. President's Comments – Joseph Omo-Osagie
7. STUDY SESSION – Funded Program Midyear Presentations
 - A. CCHCC Disability Services (**pages 3-24**)
Claudia Lenhoff, Executive Director of the Champaign County Health Care Consumers, will report on the new Disability Application Services program.
 - B. WIN Recovery (**pages 25-35**)
Bethany Little, Executive Director of Women in Need Recovery, will report on the Re-entry and Recovery Home program.
8. Board Announcements
9. Adjournment

****Board action requested***

#3

Instructions for participating in Zoom Conference Bridge for CCMHB Study Session January 26, 2022 at 5:45 p.m.

You will need a computer with a microphone and speakers to join the Zoom Conference Bridge; if you want your face broadcast you will need a webcam.

Go to Join Zoom Meeting
<https://us02web.zoom.us/j/81393675682>
Meeting ID: 813 9367 5682

One tap mobile

+13126266799,,81393675682# US (Chicago)
+13017158592,,81393675682# US (Washington D.C)

Dial by your location

+1 312 626 6799 US (Chicago)
+1 301 715 8592 US (Washington D.C)
+1 646 558 8656 US (New York)
+1 669 900 9128 US (San Jose)
+1 253 215 8782 US (Tacoma)
+1 346 248 7799 US (Houston)

Meeting ID: 813 9367 5682

Find your local number: <https://us02web.zoom.us/u/kclgvKiumy>

When the meeting opens, choose to join with or without video. (Joining without video doesn't impact your participation in the meeting, it just turns off YOUR video camera so your face is not seen. Joining without video will also use less bandwidth and will make the meeting experience smoother).

Join with computer audio.

Once you are in the meeting, click on "participants" at the bottom of the screen.

Once you've clicked on participants you should see a list of participants with an option to "Raise Hand" at the bottom of the participants screen. **If you wish to speak, click "raise hand" and the Chair will call on you to speak.**

If you are not a member of the CCMHB or a staff person, **please sign in by writing your name and any agency affiliation in the Chat area.** This, like the recording of the meeting itself, is a public document. There are agenda items for Public Participation and for Agency Input, and we will monitor the 'raised hands' during those times.

If you have called in, please speak up during these portions of the meeting if you would like to make a contribution. If you have called in and therefore do not have access to the chat, there will be an opportunity for you to share your 'sign-in' information. If your name is not displayed in the participant list, we might ask that you change it, especially if many people join the call.

Members of the public should not write questions or comments in the Chat area, unless otherwise prompted by the Board, who may choose to record questions and answers there.

Disability Application Services

Presentation to CCMHB by: Champaign County Health Care Consumers (CCHCC)



#7.A.



This presentation will cover:

- What is “disability” as a benefit
 - The need for Disability Application Services
 - CCHCC’s Disability Application Services program
 - CCHCC Program updates
- 

**What is “Disability”
as a benefit?**

What is “Disability” as a benefit?

- “Disability”, as a benefit refers to the income supports programs that provide beneficiaries with monthly income, made available by State and

Federal governments:

- **SSDI** – Social Security Disability Income – available to individuals who have had paychecks and worked enough quarters. Paid through Social Security Administration (SSA); a form of early retirement due to disability. Benefit amount is based on earnings history.
- **SSI** – Supplemental Security Income – means-tested program for low- or no-income individuals (federal/state partnership). Benefit amount in 2022 in IL is \$841/mo.

About “Disability” as a benefit, cont’d.

“Disability” is granted when an individual can successfully demonstrate that their health condition(s) prevent them from engaging in Substantial Gainful Activity (SGA) employment.

- This means that, because of their disabling condition(s), they cannot earn enough to live on.
- For 2022, SGA for non-blind individuals is \$1,350 per month. So, if someone is “disabled” and earning less than the SGA amount, they should consider applying for disability. (Notice that SSI does not pay SGA!)

About “Disability” as a benefit, cont’d.

When someone qualifies for “disability” – whether SSDI, SSI, or both, they also become eligible for many more benefits and resources on the basis of having been deemed “disabled”.

- Benefits can include subsidized housing, LIHEAP, free phones, free or reduced cost transportation, tax breaks on home property taxes, etc.
- Therefore, qualifying for “disability” can lead to even more benefits and more affordable living.



The need for Disability Application Services



The need for Disability Application Services

- Applying for “disability” is notoriously difficult.
 - It is time-consuming, tedious, and attention to detail and ability to respond in a timely manner is crucial.
 - The people who are most in need of “disability” benefits are often the people who are least able to navigate the complex and tedious application system.
 - Consistent and ongoing medical documentation is essential. Technological capacity is very helpful.

The need for Disability Application Services, cont'd.

- Applying for “disability” can take months, or even years, especially in Illinois.
 - In IL, the **Disability application denial rate is 71.1%**.
 - In IL, the Disability application approval rate is 28.9%.
 - If one’s application is denied, one can file appeals. Sometimes this process can take years.
 - Having a disabling condition (or conditions) is NOT enough. One must demonstrate how the condition(s) impact ability to function **and** earn SGA.

The need for Disability Application Services, cont'd.

- People need help knowing about, and applying for “disability”.
- Attorneys do not help with initial applications. However, they can assist with appeals, and then they will be paid out of the client’s “lump sum payment”, once the client is approved.
- Until now (and on a limited basis), *CCHCC is the only organization in Champaign County to provide disability application assistance services to community members.*
 - Some health provider organizations provide some assistance to their established patients.

The need for Disability Application Services, cont'd.

- Research shows that people who have "advocates" helping them with disability applications are far more likely to be approved for benefits.
- People who are homeless are more likely to have qualifying disabling conditions.
 - People who are homeless are more likely to have traumatic brain injuries (TBIs), making the application process even more challenging.
- People who have been incarcerated are more likely to have qualifying disabling conditions as well (Reentry population).

The need for Disability Application Services, cont'd.

- Medical providers often cannot and do not provide documentation on how the disabling condition(s) limit the person's ability to function.
 - This documentation and the ability to articulate it, is crucial for a successful application.
- Champaign County residents are under-enrolled in SSI/SSDI. CCHCC believes that too many county residents are functionally disabled but have not accessed the benefits for which they might qualify.
- Not only do the individuals need this benefit, but getting people qualified will also benefit the community and will help reduce strain on social services.

CCHCC's Disability Application Services Program

CCHCC's Disability Application Services Program

- CCHCC's Disability Application Services Program is a new program made possible through the CCMHB, with County ARPA funding.
- CCHCC's program is focused on serving individuals with behavioral health issues and homeless individuals.
- CCHCC's services are provided free of charge.
- CCHCC's program is "conflict-free" – meaning that CCHCC serves clients regardless of who their healthcare providers are, or if they do not yet have health care providers.
- CCHCC is the only organization in the county that makes these services available to community members at large.

CCHCC's Disability Application Services Program, cont'd.

- CCHCC is in an ideal position to provide these services, because we can also link clients with health care access and resources (for example: health insurance, Rx cost assistance, SNAP/LINK, access to health services, case management services, housing vouchers, etc.).
- Most CCHCC staff are bi-lingual (English/Spanish).
- CCHCC has staff trained in SOAR.

CCHCC's Disability Application Services Program, cont'd.

- SOAR is a methodology for doing disability applications and getting them approved rapidly, especially for homeless individuals and/or individuals who cannot always actively participate in their own disability applications.
- SOAR stands for SSI/SSDI Outreach, Access, and Recovery, and is funded by the Substance Abuse and Mental Health Services Administration (SAMHSA) and is a national program designed to increase access to the disability income benefit programs administered by the Social Security Administration (SSA) for eligible adults and children who are experiencing or at risk of homelessness and have a serious mental illness, medical impairment, and/or a co-occurring substance use disorder.

CCHCC's Disability Application Services Program, cont'd.

- CCHCC uses both the SOAR method, as well as more traditional methods for working with individuals who are applying for disability.
- The SOAR method depends a lot on the local Social Security Administration (SSA) office and staff, and requires building a relationship between the SSA and community agencies. This is especially challenging during the pandemic.
- CCHCC works with clients who are at various stages of the disability application process – some clients need help with submitting an initial application, while others come to CCHCC needing help with an appeal, and many are simply unsure where in the process their disability case is. CCHCC helps clients at all stages of the disability application process.

CCHCC's Disability Application Services Program, cont'd.

- Part of our work involves identifying what kind of medical documentation is needed for the client's case, and helping them access that health care.
- Program staff for this program include:
 - Claudia Lennhoff, Exec. Dir., experienced with disability applications;
 - Paulette Coleman Peebles, SOAR Trained, experienced with disability applications;
 - Ashley Buckley, some experience with disability applications, and extensive experience in medical documentation; and,
 - Full-time Disability Application Services Specialist

CCHCC Program Updates

CCHCC Program Updates

- Goal is to serve 20 individuals in this program year.
- Approved SSI/SSDI applications submitted so far: 7
- Pending new applications: 3
- Pending appeals: 2
- Early retirement – applied for early retirement Social Security payments: 1
- Clients being served have come from: Urbana, Champaign, Tolono, and Rantoul.
- Staffing updates

Questions?

Thank You!

Champaign County Health Care Consumers (CCHCC)



(217) 352-6533

www.healthcareconsumers.org

Email: cchcc@cchcc-il.org

facebook.com/healthcareconsumers

twitter.com/cchcc1977

#7.B.



RE-ENTRY HOUSING IN ILLINOIS

FEMALE INCARCERATION IN ILLINOIS

Women are the fastest growing prison population in America.

Women represent **20%** of all returning residents each year, but there is little attention paid to women's reentry.

Women's needs are unique in the types of treatment needed for past trauma, substance misuse, escaping poverty, and meeting the needs of their children and families.

Women In Need (WIN) Recovery

- ▶ Women In Need (WIN) Recovery, a non-profit based in Champaign, Illinois, was founded in 2015 to support women and members of the LGBTQ community who are successfully completing substance abuse treatment and/or have recently been released from prison.
- ▶ WIN's peer-led, transition housing model aims to decrease the rate at which women relapse into substance abuse and return to prison.
- ▶ WIN provides a stable living environment in addition to employment and educational assistance, peer mentorship on topics including healing from trauma, personal finance, and parenting, and additional supports and wraparound services needed to help residents meet their goals and reach their potentials.



WIN RECOVERY'S SAFE HOUSING MODEL
stems from A New Way of Life's Sisterhood Alliance
for Freedom and Equality (SAFE) Housing network

Sisterhood Alliance for Freedom and Equality (SAFE) Housing Network

Mission:

to advance a national model for wraparound reentry support services that are flexible enough to meet the unique needs of every person, including legal help, mental health treatment, parenting and life skills instruction, substance misuse training, employment assistance, and everything in between.

This model is proven to have better outcomes than traditional transitional housing, while reducing expenses for taxpayers in the long run.



AT WIN, WE PROVIDE HOLISTIC AND INDIVIDUALIZED SERVICES TO THE CLIENTS WE SERVE

Wraparound Services Provided

- ▶ LEGAL SERVICES
- ▶ MENTAL HEALTH TREATMENT
- ▶ PARENTING AND LIFE SKILLS
- ▶ SUBSTANCE MISUSE
- ▶ EMPLOYMENT
- ▶ TRAUMA-INFORMED & GENDER-SPECIFIC SUPPORT
- ▶ FAMILY REUNIFICATION



Outcomes

- ▶ INCREASE SELF-EFFICACY
- ▶ IMPROVED RELATIONSHIPS WITH FAMILY & COMMUNITY
- ▶ CONTINUED RECOVERY
- ▶ VOICE FOR FORMERLY INCARCERATED WOMEN
- ▶ **SUCCESESFUL RE-ENTRY**

ABOUT THE SAFE HOUSING NETWORK



Women in Need (WIN) Recovery

WIN's peer-led, transition housing model aims to decrease the rate at which women and members of the LGBTQ community relapse into substance abuse and return to prison.

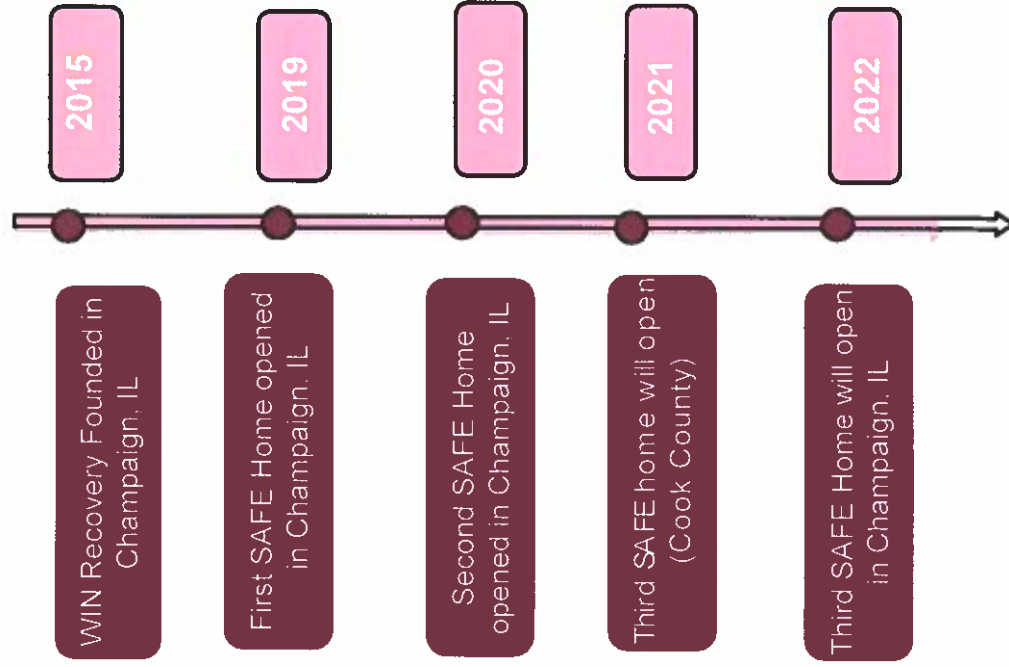

WIN RECOVERY – A SAFE HOME

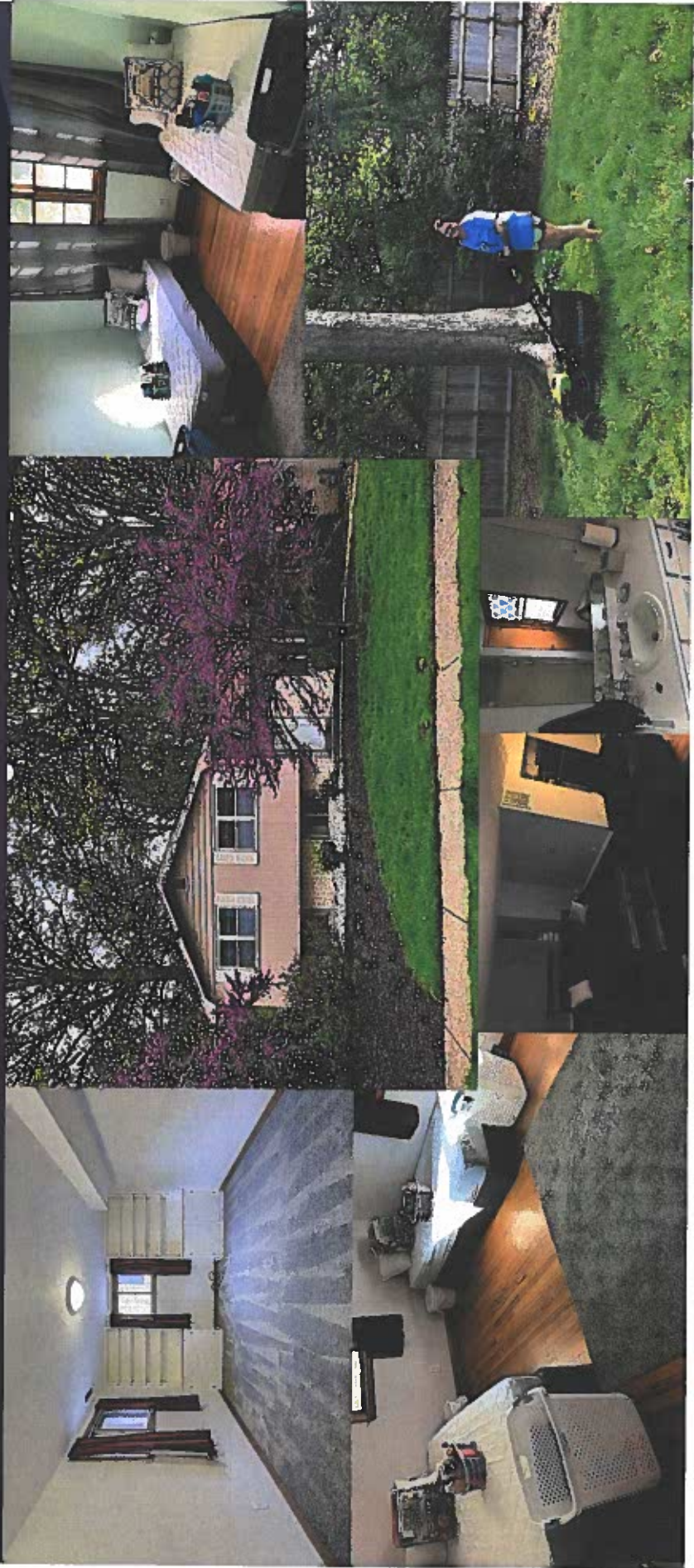

WIN RECOVERY – A SAFE HOME



COMMUNITY-BASED & COMMUNITY BUILDING WIN COMMUNITY PARTNERSHIPS

Programs work better when they are close to home.
WIN Recovery's program coordinates and partners with a variety of providers in Champaign County.

<p>Housing Authority of Champaign County</p>	<ul style="list-style-type: none"> - HACC provides a Move to Work voucher program for Clients - Voucher helps Clients secure housing in Champaign County - Must maintain a full-time job or full-time education to be eligible - Clients receive additional services to assist with gaining homeownership
<p>Mental Health Board of Champaign County</p>	<ul style="list-style-type: none"> - Provides support and resources for our trauma-informed care
<p>University of Illinois Urbana-Champaign</p>	<ul style="list-style-type: none"> - U of I provides education and internship opportunities for Clients - Clients may enroll in Odyssey program to work towards educational goals - WIN provides U of I students with internship opportunities
<p>Community Foundation of East Central Illinois & United Way of Champaign County</p>	<ul style="list-style-type: none"> - CF's Community Solutions Incubator provides WIN with hands-on mentorship and guidance, networking opportunities, workshops, seminars, and limited access to financial support - United Way of Champaign County has granted us a Diversity & Inclusion grant